

Building connections that last™



Series S77CV

316 Stainless Steel Sanitary Clamp
End Check Valve Datasheet



SCI

An ASC Engineered Solution

316 Stainless Steel Sanitary Clamp End Check Valve

Series S77CV



Design Features

- 316 Stainless Steel
- Tri-Clamp Ends
- 150 psi at ambient temperature
- All wetted parts approved for use in food processing
- All wetted parts polished to 180 grit

Parts & Materials

No.	Part	Material
1	Short Body	316 Stainless Steel
2	Long Body	316 Stainless Steel
3	Clamp	304 Stainless Steel
4	Clamp Gasket	Silicone
5	Seal-Ring	Silicone
6	Spring	316 Stainless Steel
7	Flow Support Plate	316 Stainless Steel
8	Disc	316 Stainless Steel

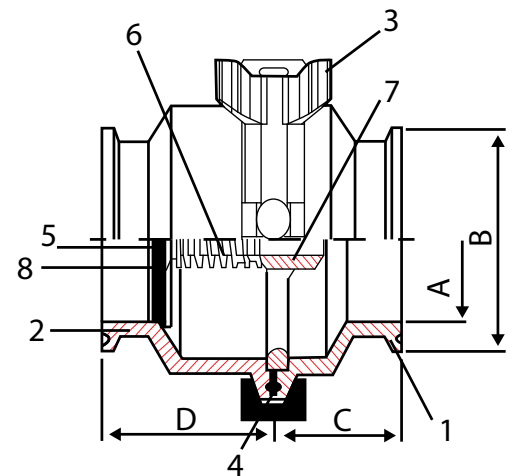

Dimensions

Size	Part Number	A	B	C	D	Cracking Pressure	Weight
In		In	In	In	In	psi	Lb
1-½	S7745MP6014	1.37	1.98	2.30	1.63	1.16	2.27
2	S7745MP6020	1.87	2.52	2.66	1.75	1.16	3.53
3	S7745MP6030	2.87	3.58	3.05	1.91	1.16	5.89
4	S7745MP6040	3.84	4.68	3.41	2.03	1.45	9.37

About ASC Engineered Solutions

ASC Engineered Solutions is defined by quality—in its products, services and support. With more than 1,400 employees, the company's portfolio of precision-engineered piping support, valves and connections provides products to more than 4,000 customers across industries, such as mechanical, industrial, fire protection, oil and gas, and commercial and residential construction. Its portfolio of leading brands includes ABZ Valve®, AFCON®, Anvil®, Anvil EPS, Anvil Services, Basic-PSA, Beck®, Catawissa, Cooplet®, FlexHead®, FPPI®, Gruvlok®, J.B. Smith, Merit®, North Alabama Pipe, Quadrant®, SCI®, Sharpe®, SlideLOK®, SPF® and SprinkFLEX®. With headquarters in Commerce, CA, and Exeter, NH, ASC also has ISO 9001:2015 certified production facilities in PA, TN, IL, TX, AL, LA, KS, and RI.



asc-es.com

Building connections that last™

